



Watson Place, Haverhill, CB9 7QE

Rent - Offers In The Region Of £260,000

Deposit -

Located in the charming village of Withersfield, Haverhill, this modern end-of-terrace house on Watson Place offers a delightful blend of comfort and style. As you enter, you are greeted by a generous entrance hall that leads seamlessly into a spacious kitchen diner, perfect for both casual meals and entertaining guests. The large downstairs cloakroom adds to the convenience of this well-designed home.

The inviting lounge boasts French doors that open directly onto a low-maintenance south-facing garden, creating a lovely indoor-outdoor flow that is ideal for enjoying sunny days. This outdoor space is perfect for relaxation or

- SPACIOUS TWO BEDROOM END OF TERRACE PROPERTY
- SPACIOUS DOWNSTAIRS CLOAKROOM
- TWO DOUBLE BEDROOMS WITH BUILT IN WARDROBES
- LOW MAINTENANCE SOUTH FACING GARDEN
- CAMBRIDGE SIDE OF TOWN
- MODERN KITCHEN/DINER
- GENEROUS LOUNGE WITH FRENCH DOORS TO GARDEN AREA
- MODERN SHOWER ROOM WITH TWO PIECE WHITE SUITE
- ALLOCATED PARKING FOR ONCE CAR
- MODERN DEVELOPMENT



Council Tax Band: B - EPC Rating: null

Ground Floor

Approx. 36.8 sq. metres (396.5 sq. feet)

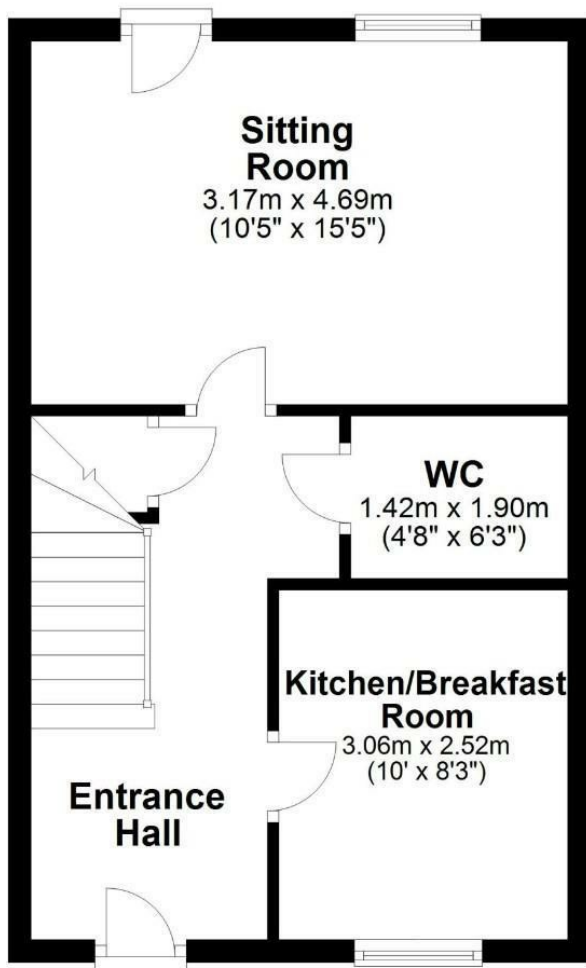

First Floor

Approx. 36.8 sq. metres (396.5 sq. feet)

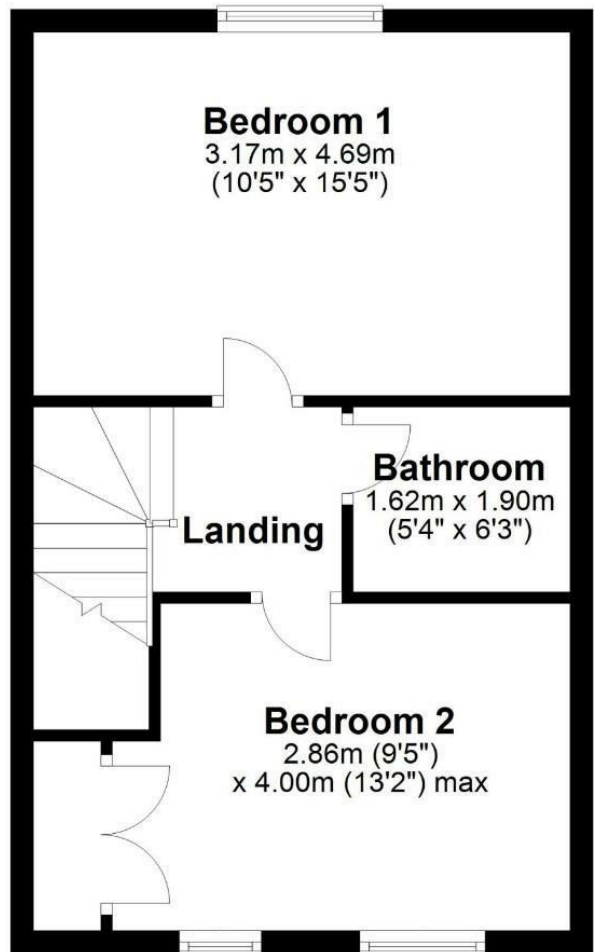

Total area: approx. 73.7 sq. metres (792.9 sq. feet)

